

## CHAPTER 6: CONTROL SYSTEM

6- 1	SPECIFICATIONS AND STANDARDS FOR CONTROL SYSTEM ...	6- 1
6- 2	REMOVAL AND REINSTALLATION OF GEAR SHIFT SYSTEM ...	6- 1
6- 3	REMOVAL AND REINSTALLATION OF THE FUEL STRAINER ASSEMBLY (SEDAN) .....	6- 4
6- 4	DISASSEMBLY AND REASSEMBLY OF FUEL STRAINER PARTS (SEDAN) .....	6- 5
6- 5	REMOVAL AND REINSTALLATION OF THE FUEL STRAINER ASSEMBLY (CUSTOM) .....	6- 9
6- 6	REMOVAL AND REINSTALLATION OF THE FUEL TANK (SEDAN)	6-10
6- 7	REMOVAL AND REINSTALLATION OF THE FUEL TANK (CUSTOM)	6-11
6- 8	REMOVAL AND REINSTALLATION OF THE MUFFLER AND EXHAUST PIPE .....	6-12
6- 9	CLUTCH PEDAL .....	6-13
6-10	REMOVAL AND REINSTALLATION OF CLUTCH CABLE .....	6-14



## CHAPTER 6: CONTROL SYSTEM

### 6-1: SPECIFICATIONS AND STANDARDS FOR CONTROL SYSTEM

	SEDAN	CUSTOM
Fuel Strainer Mesh	105 mesh	element
Upper Filter		type
Lower Filter	177 mesh	
Fuel Strainer Capacity	300-350cc/min at 200mm Hg	Same as sedan
Fuel Strainer Functional Power	OFF-ON 1.2-0.4 kg	-
	On-OFF 2.7-3.5 kg	-
Fuel Tank Capacity	25 liters (6.60 USgal) (5.5 Imp.gal)	20 liters (5.3 USgal) (4.4 Imp.gal)
Neutral Set Spring	Spring Constant	0.232 kg/mm
		Same as sedan
Accelerator Pedal Standard Position	About 60 mm from floor to pedal tip.	-
Clutch Pedal Paly	20-25 mm (0.79-0.98 in)	

### 6-2: REMOVAL AND REINSTALLATION OF GEAR SHIFT SYSTEM

#### A. REMOVAL

- (a) Place the vehicle over a work pit or raise on a jack.
- (b) Remove the two 6 mm screws holding the back rest of the rear seat and fold the back rest forward. A trap door will appear.
- (c) Remove both the left and right trap doors. In the case of the custom, remove the mat and open the trap door.

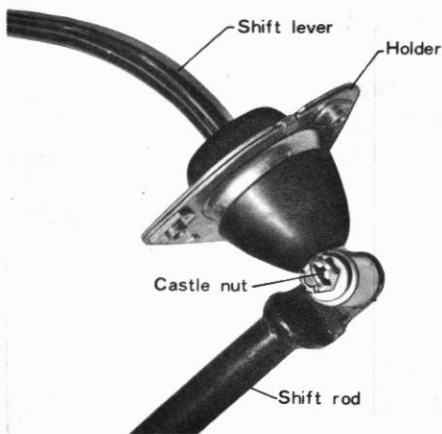
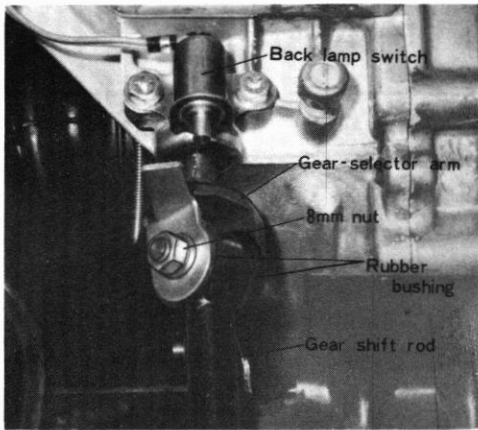

- (d) Remove the 8 mm nut and separate the gear shift rod and the gear-selector arm shaft.
- (e) On underneath the body, take out the 2 mm cotter pin from the castellated nut 8 mm joining the end of the shift lever and remove nut, washer (2), spring A, and bushing A (2) in this order. The gear shift rod can be freed downward.
- (f) In the cabin, remove the rubber boot from the gear shift lever. Loosen the three 6 mm screws holding the bracket and the shift lever can be pulled free inside the cabin.

## B. REINSTALLATION

- (a) Insert the shift lever, bracket, spring bushing B and rubber boot as a unit into the tunnel and fasten the bracket temporarily with the 6 mm bolt.
- (b) Insert the bushing A into the hole on the gear shift lever end and, fix the gear shift rod with the washer, spring and washer through the gear shift lever hole and tighten the 8 mm castellated nut in place.
- (c) Fix the gear shift rod with the 8 mm nut to the gear selector arm shaft.
- (d) Operate the gear shift lever and adjust so that the knob is at the correct position by moving the bracket back and forth. Fix in place with the 6 mm bolt.

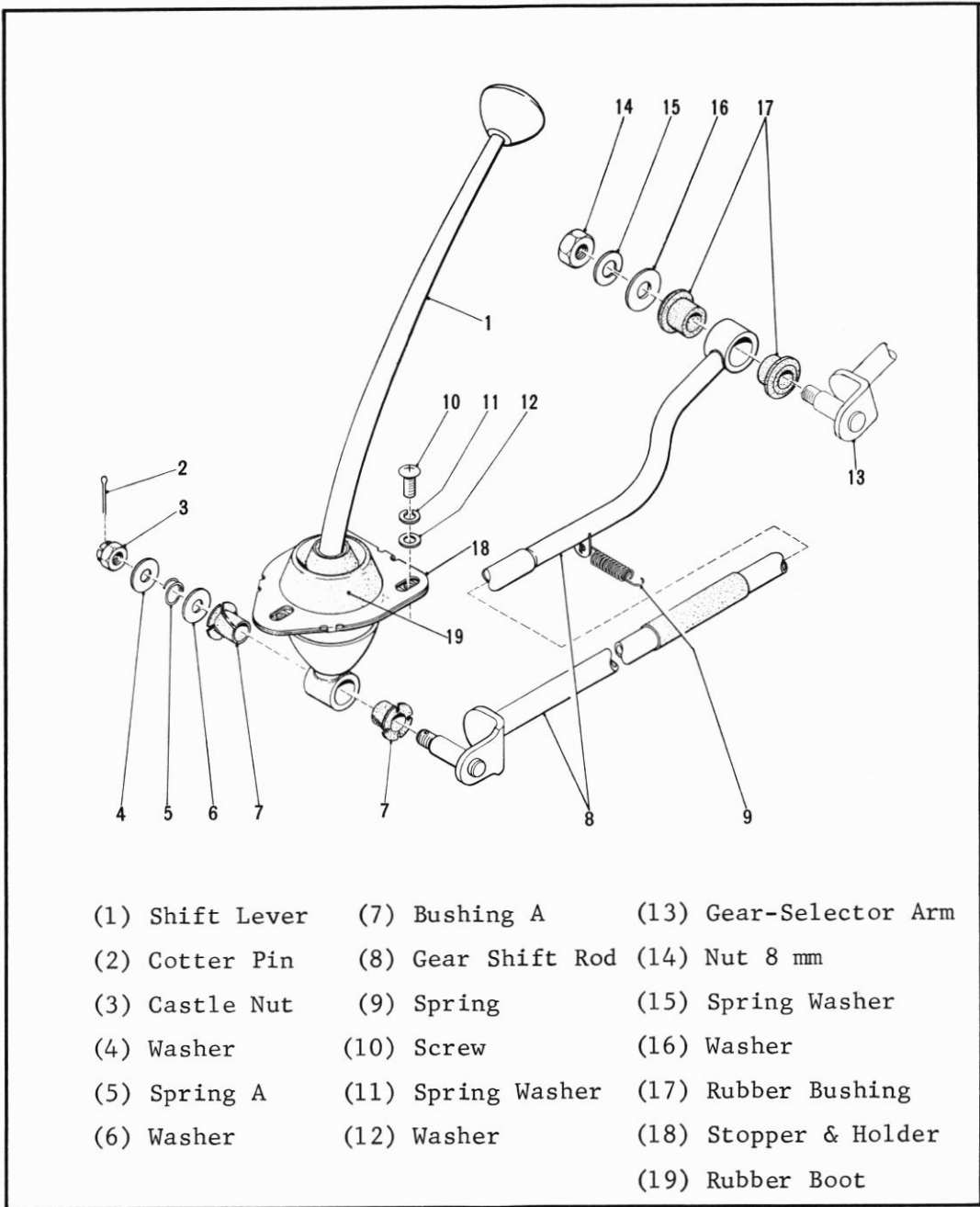

(e) At the end, fasten the shift lever rubber boot on the tunnel.

C. COMPOSITION OF GEAR SHIFT LEVER

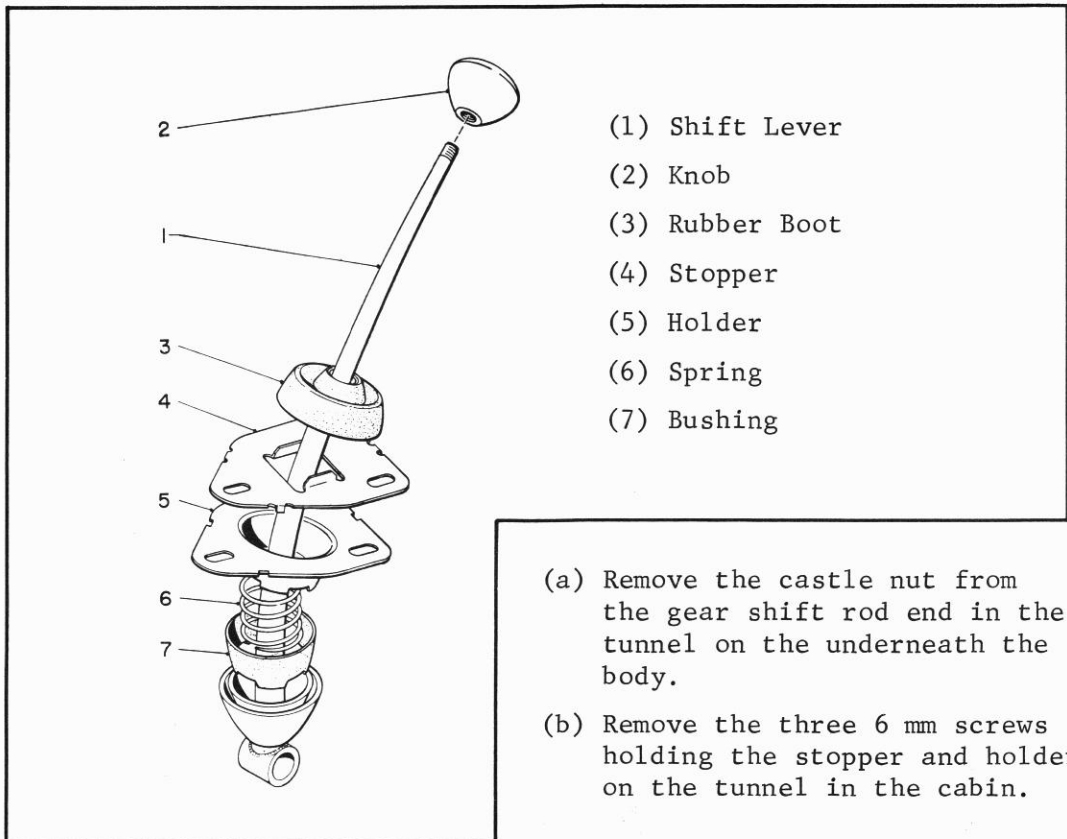

- (a) Remove the castle nut from the gear shift rod end in the tunnel on the underneath the body.
- (b) Remove the three 6 mm screws holding the stopper and holder on the tunnel in the cabin.

- (c) Reassembly is effected by performing the disassembly procedures in revers. Be careful of the following points during reassembly.
- (d) Check the bushing B, spring and rubber boot, if they are shows excessive wear and any clameges, exchange for a new parts.

**6-3: REMOVAL AND REINSTALLATION OF THE FUEL STRAINER ASSEMBLY (SEDAN)**

**A. REMOVAL**

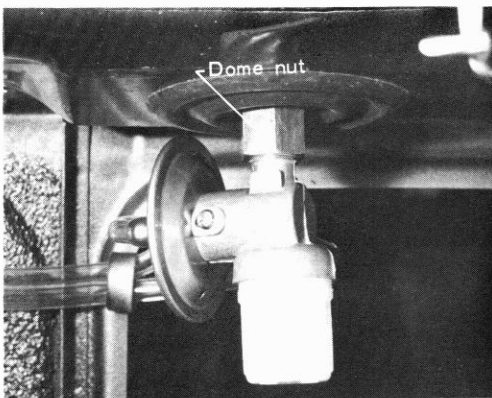

Remove through the following procedures: