

## CHAPTER 11: EQUIPMENT

11-1	REMOVAL AND REINSTALLATION OF HEATER .....	11-1
11-2	SAFETY BELT (OPTIONAL) .....	11-3
11-3	SUN VISOR .....	11-4



11-1: REMOVAL AND REINSTALLATION OF HEATER

1: HEATER BLOWER MOTOR

A. REMOVAL OF THE HEATER BLOWER MOTOR

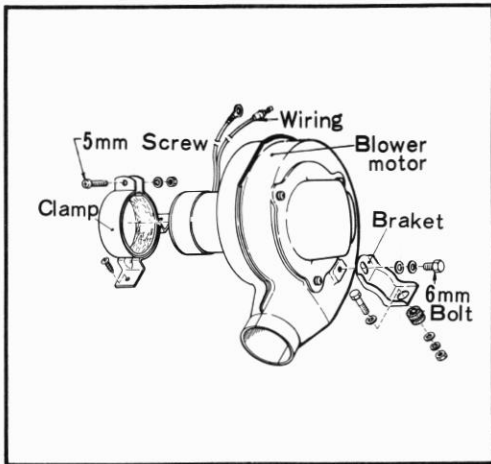

- (a) Remove the rear seat.
- (b) Remove the cabin duct hose from the blower motor.
- (c) Disconnect the motor cord from the wiring harness.
- (d) Loosen the 5 mm screw on the clamp holding the blower motor and remove the installation bold on the blower motor with the spring washer, plain washer and the blower motor will become free.

B. REINSTALLATION

- (a) Insert the blowe motor into the clamp holding it, and fix the 5 mm screw on the clamp and 6 mm bolt on the bracket of the blower motor.
- (b) Install the cabin duct hose of the both side and connect the blower motor cord to the wiring harness.

2: HEATER CHANGE LEVER AND JOINT

- |                    |                    |
|--------------------|--------------------|
| (1) Joint Assembly |                    |
| (2) Lever          | (5) 4 mm Screw     |
| (3) Body           | (6) Defroster Hose |
| (4) Valve          | (7) Heater Out Let |
|                    | (8) Stopper        |

- (a) The change lever is equipped for controlling the air flow toward Room and Defroster, under the front seat.
- (b) When removal of the heater change lever, remove the two 4 mm tapping screws on the stopper and pull out the joint assembly under the front seat.

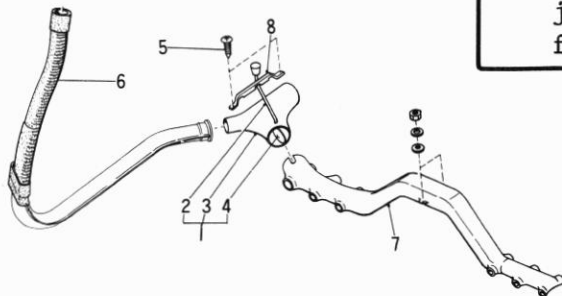

### 3: HEATER LEVER, CONTROL CABLE AND HEATER VALVE

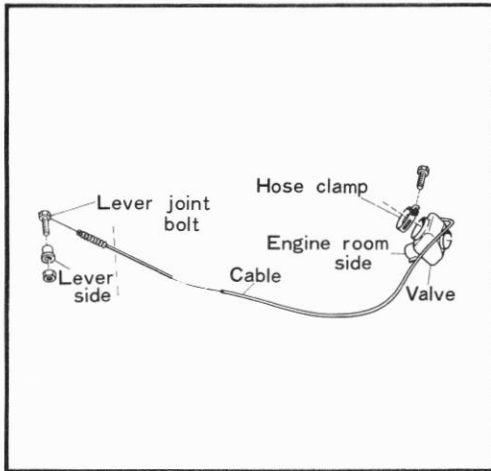

- (a) The engine cooling air is used for room heater. The heater lever marked "H" is located on the floor at the front of the front seat. When pulling the lever toward you, the heater begins to work.
- (b) The heater valve is located on the rear bulkhead of the engine room side.
- (c) The heater control cable connects between the heater valve and the heater lever, when removal of the heater

control cable, loosen the bolts jointing the both side of the cable end and take out the cable.

### 4: INSTALLATION OF HEATER SYSTEM

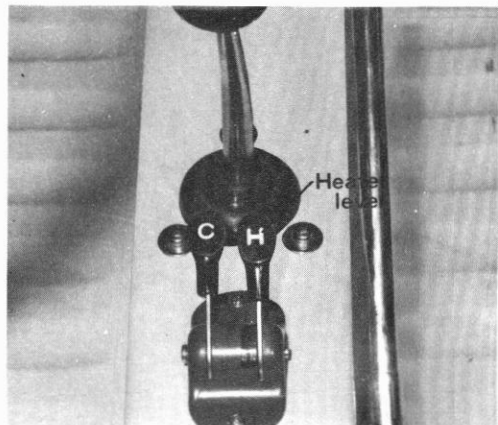
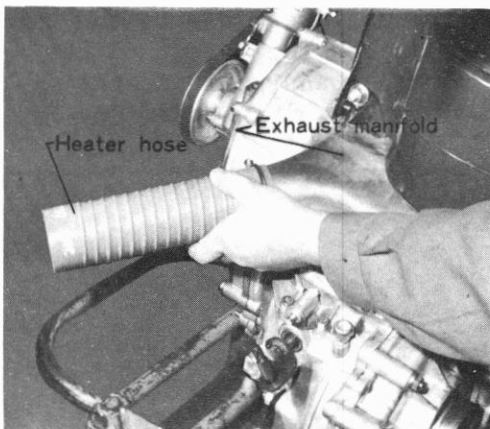
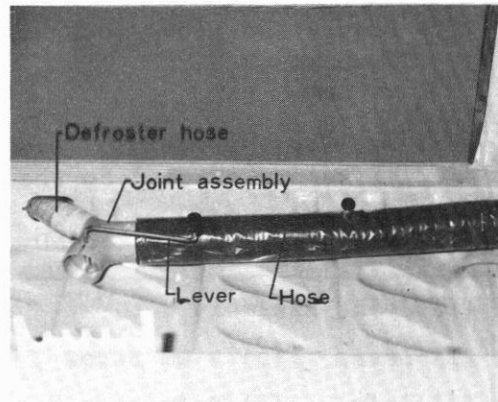
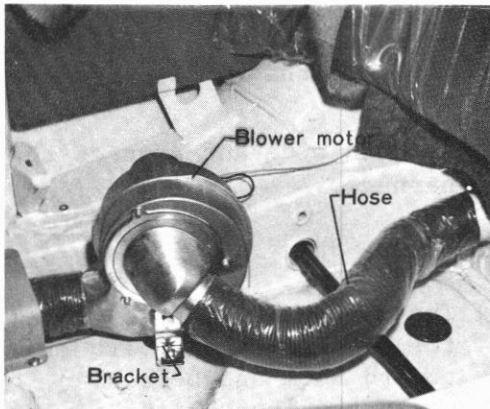

## 11-2: SAFETY BELT (OPTIONAL)

Subaru 360 sedan can be equipped with the lap type safety belt on the front seat and rear seat.

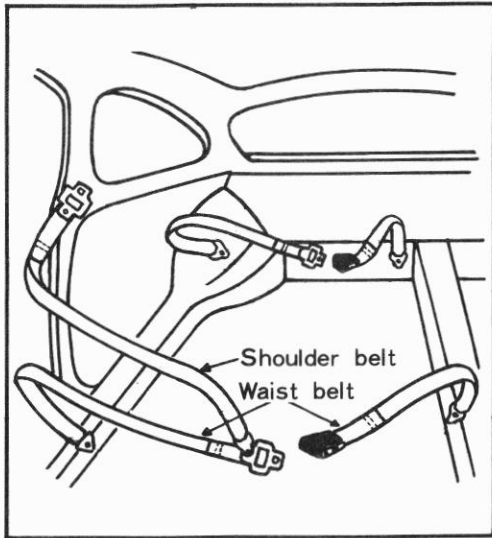

### (a) FOR FRONT SEAT

The front seat safety belt is installed the three-point on the body with the 12 mm bolts as shown in the picture.

### (b) FOR REAR SEAT

The rear seat safety belt is installed the two-point on the body with 12 mm bolts as shown in the picture.



Front Seat Belt



Rear Seat Belt

The installation nut is already welded at the each points on the body.

### 11-3: SUN VISOR

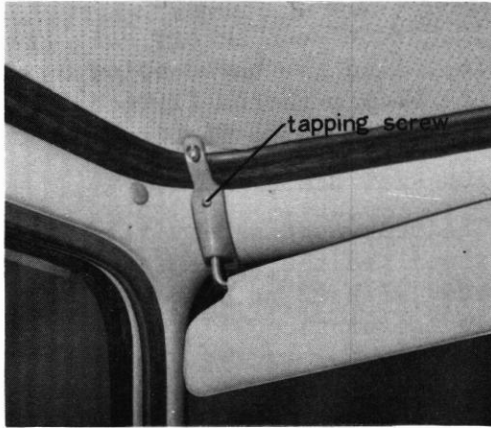

Sun visors are provided on both sides of the rear-view mirror with the 4 mm tapping screws.